

## Endstop Connector Mod. V4750

Used for closing microduct

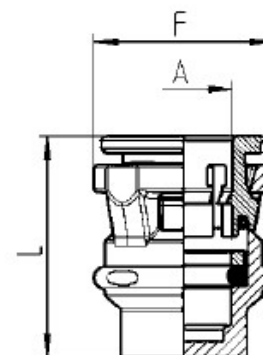

### DIMENSIONS

Mod.	A	F	L	Weight (g)	Package (pieces)
<b>V4750 3</b>	3	10	16.5	1	25
<b>V4750 4</b>	4	10	16.5	1	25
<b>V4750 5</b>	5	12.5	21.5	2	25
<b>V4750 7</b>	7	16.5	22.5	3	25
<b>V4750 8</b>	8	17.5	23.5	3	25
<b>V4750 8,5</b>	8.5	17.5	23.5	3	25
<b>V4750 10</b>	10	20.5	26	4	25
<b>V4750 12</b>	12	23	28	6	25
<b>V4750 12,7</b>	12.7	23	28	6	25
<b>V4750 14</b>	14	25.5	32.5	8	10
<b>V4750 15</b>	15	27	33	9	10
<b>V4750 16</b>	16	30	36	13	10
<b>V4750 18</b>	18	33.5	42	18	10